

Radial Duct Inline Tube Fan - Speed Controller



**FRESH AIR
SUPPLIES**

Dimensions

On-surface mounting

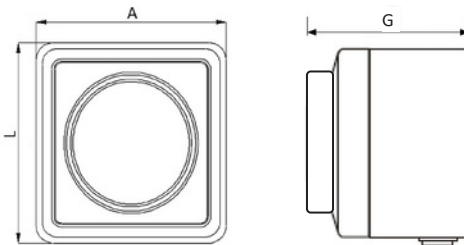

L [mm]	A [mm]	G [mm]
80	80	60

Flush mounting

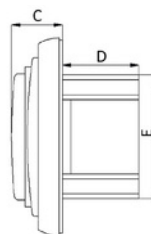

C [mm]	D [mm]	E [mm]
24	36	50

Description

The DV-REG-L electronic speed controllers are designed for adjusting the operating speed in single-phase fan motors. They can only be wired to fans driven by single-phase voltage-

controlled speed motors. A single DV-REG-L speed control can manage several motors up to the current rating of the device. The product cannot be wired to motors with external overtemperature protection.

Mounting: On-surface or flush mounted.

Control principle: pot-meter

Infinitely variable speed control

Pot-meter-integrated ON/OFF switch

Minimum speed adjustable via an internal control unit.

Control:

P1 – the hard start time setpoint trimmer.

The range 0..15 sec., ± 5%.

P2 – the minimum motor rotating speed setpoint trimmer.

The range 60..150 VAC, ± 5%.

Product code example

Product code: type load DV-REG-L - aaa



Wiring connection diagram

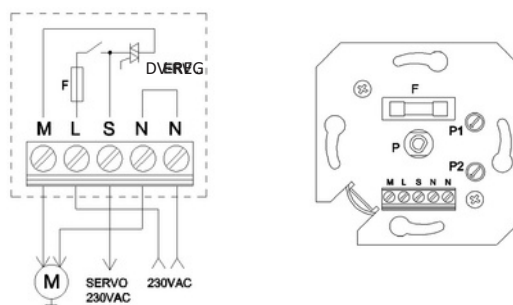

Technical specifications

Model	Voltage [V]	Rated current [A]	Weight [kg]
DV-REG-L-0,5	230	0.5	0.12
DV-REG-L-1,5	230	1.5	0.14
DV-REG-L-3	230	3.0	0.18

Terminal marking:

L, N – the supply voltage 230VAC.

M, N – the motor connection.

S (SERVO) – the output 230V for connecting actuators, relays or another devices which switching ON with the controller.

F P – the fuse.

P1 – the main setpoint potentiometer.

P2 – the hard start time setpoint trimmer.

The range 0..15 sec., ±5%.

– the minimum motor rotating speed setpoint trimmer. The range 60..150 VAC, ±5%.



Get in touch with the Fresh Air Supplies Team!



Call: +44 (0) 28 86752336



Email: sales@freshairsupplies.co.uk

IE: sales@freshairsupplies.ie